

Dサブ 高電流コネクタ Dsub High Current Contacts

Dサブ 高電流コネクタは、複合Dサブ に装着可能なコネクタです。
このコネクタは複合Dサブ に装着後、専用の治具を用いて取り外すことが可能です。



仕様 Specifications

接触抵抗 Contact resistance (Signal)	2.7mΩ max/1A
使用温度範囲 Temperature range	-65℃～+135℃
最大電流容量 Max Current rating	40A max
高電流コネクタと同軸シェル RF Shell and Signal Contact	AC1000V 60Hz at 25℃, 50% RH

材質, 表面処理 Material, Finish

インシュレータ Insulator	テフロン Teflon
コネクタ Contact	銅合金 Auメッキ Copper Alloy Au Plating
リング Ring	銅合金 Niメッキ Copper Alloy Ni Plating

高電流 ケーブル結線用 リダークアップタイプ High Current, Cable Solder cup type



Plug
DM537PH-ST-8

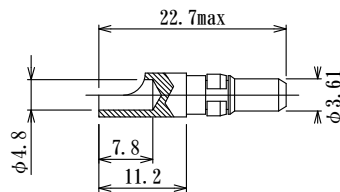

Receptacle
DM537RH-ST-8

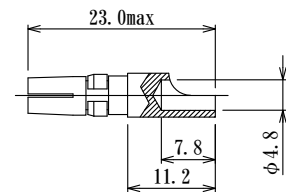

Current : 40A max

事前接地用コネクタ (Pre mating earth contact) ※

Shell size 15, 25, 37

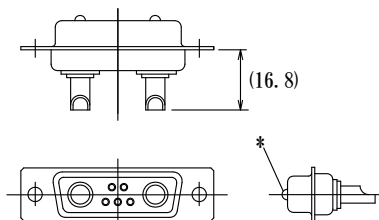

(注) ※挿入時は他のピンより先に接触し、
抜去時は最後に非接触となります。

Plug
DM537PH-STE-16

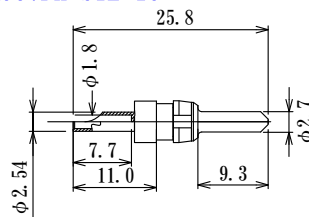

Receptacle
DM537RH-STE-16

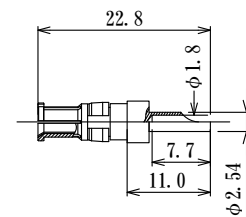

Current : 10A max

How to order (example)

DAJ7W2EP 1pcs
DM537PH-STE-8 4pcs

高電流基板用ストレートタイプ High Current Vertical, Straight type PC Board

Shell size 9, 15, 25, 37, 50
(DAJ7W2の場合)

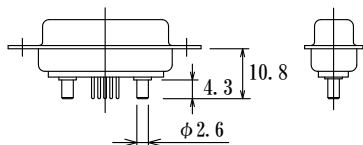

How to order (example)
DAJ7W2EP 1pcs
DM537RH-PC-V 2pcs



Plug
DM537PH-PC-V

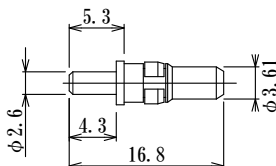

Receptacle
DM537RH-PC-V

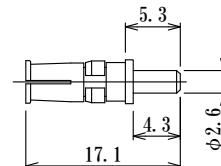

Current : 20A max

複合Dサブ、基板レイアウト Combination Dsub connectors, PC Board Layout

High Current Straight
Signal Pin Straight

高周波Dサブ 基板用ストレイトタイプのPlugを前から見たコネクタレイアウトを示します。
Receptacleの場合は左右入替の基板寸法です。

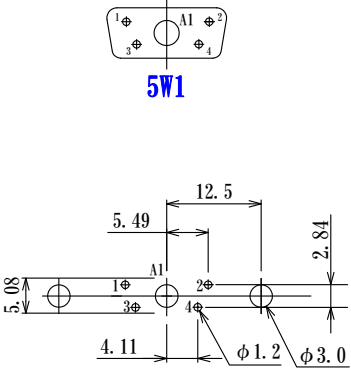
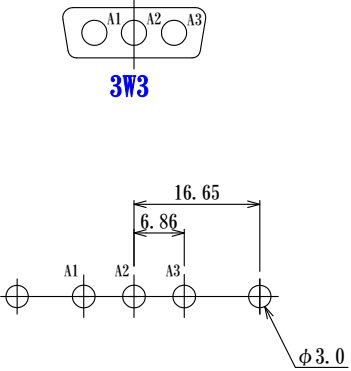
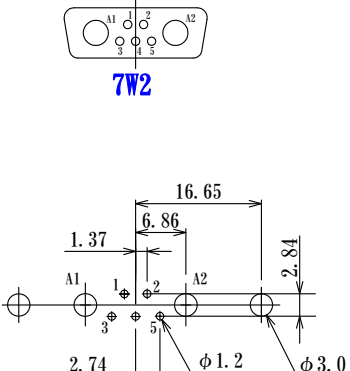
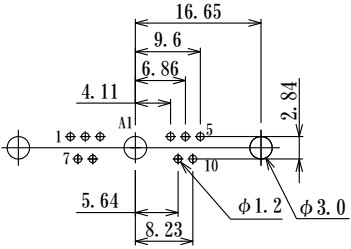
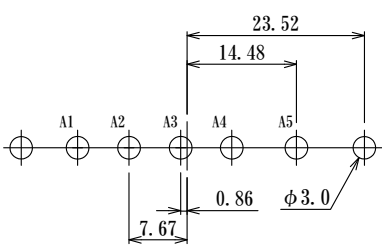
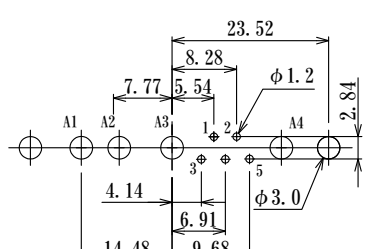
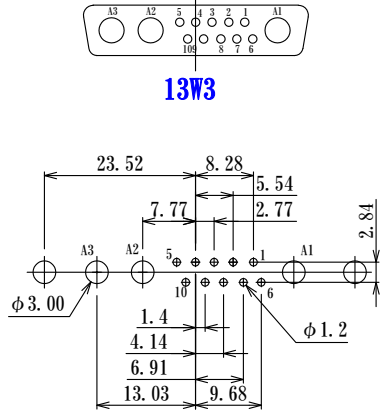
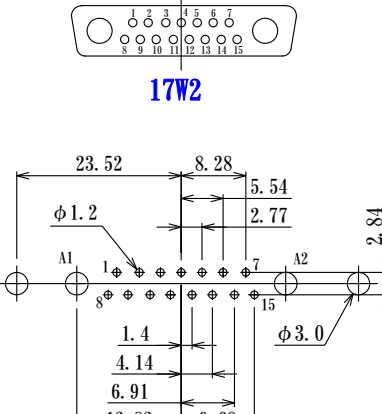
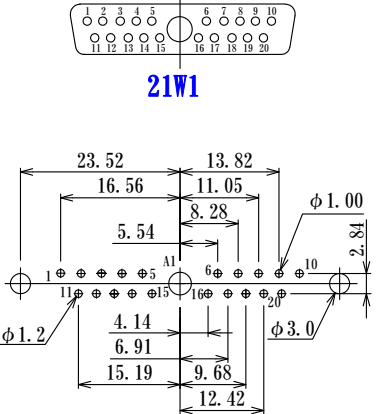
Shell Size 9	Shell Size 15	
 <p>5W1</p>	 <p>3W3</p>	 <p>7W2</p>
Shell Size 15	Shell Size 25	
 <p>11W1</p>	 <p>5W5</p>	 <p>9W4</p>
Shell Size 25		
 <p>13W3</p>	 <p>17W2</p>	 <p>21W1</p>

複合Dサブ、基板レイアウト
Combination Dsub connectors, PC Board Layout

High Current Straight
Signal Pin Straight

Shell Size 50

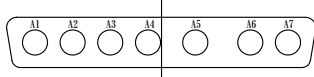

7W7

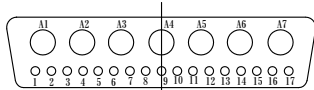
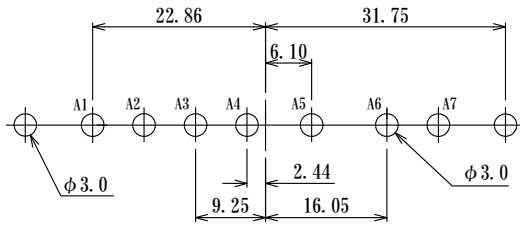

24W7

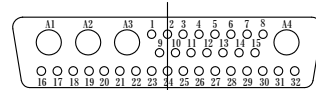
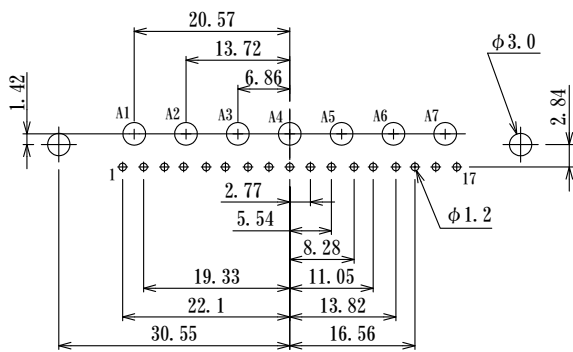

36W4

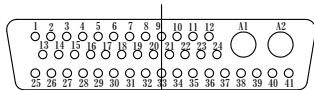
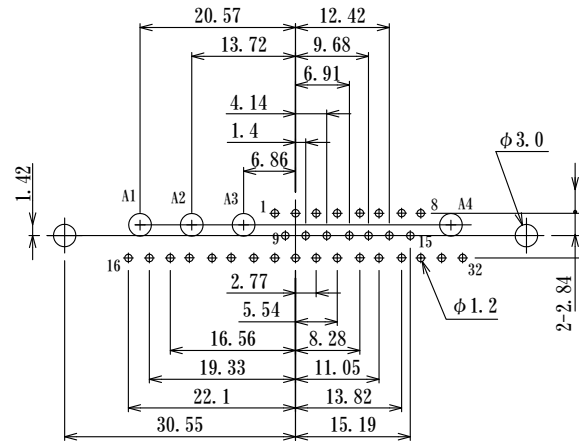

43W2

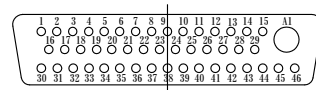
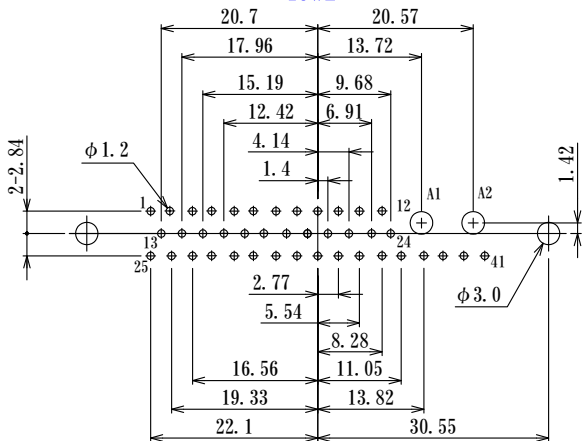

47W1

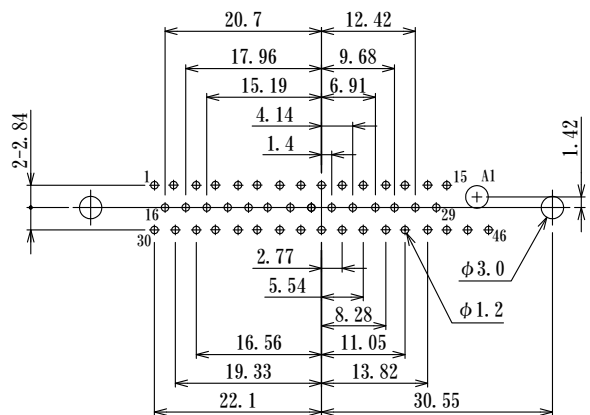

ダブ 高電流コネクタ Dsub High Current Contacts

高電流基板用アングルタイプ
High Current, Angle PC type



Shell size 15, 25, 37

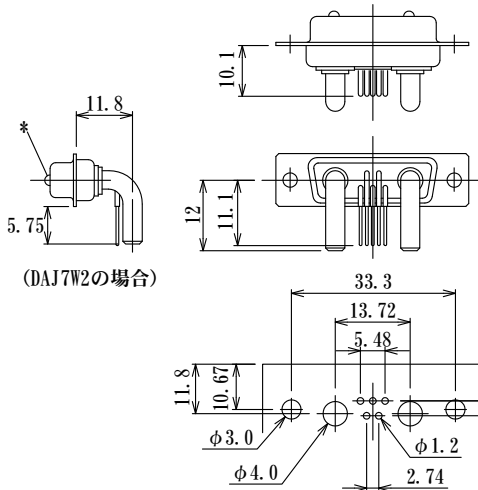

(DAJ7W2の場合)

(注) *挿入時は他のピンより先に接触し、
抜去時は最後に非接触となります。

How to order (example)
DAJ7W2ES5 1pcs
DM537PH-PCE-L1 2pcs

Plug
DM537PH-PC-L1

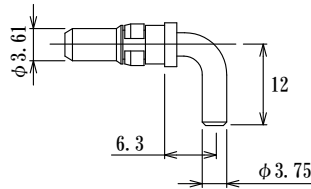

Receptacle
DM537RH-PC-L1

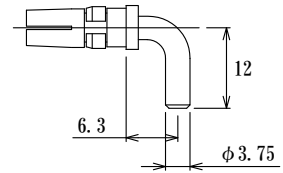

Current : 40A max

事前接触コネクタ (Pre mating earth contact) *

Plug
DM537PH-PCE-L1

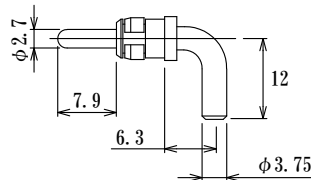

Receptacle
DM537RH-PCE-L1

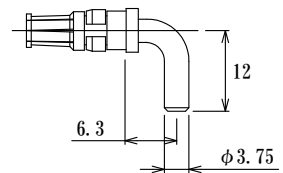

Current : 20A max

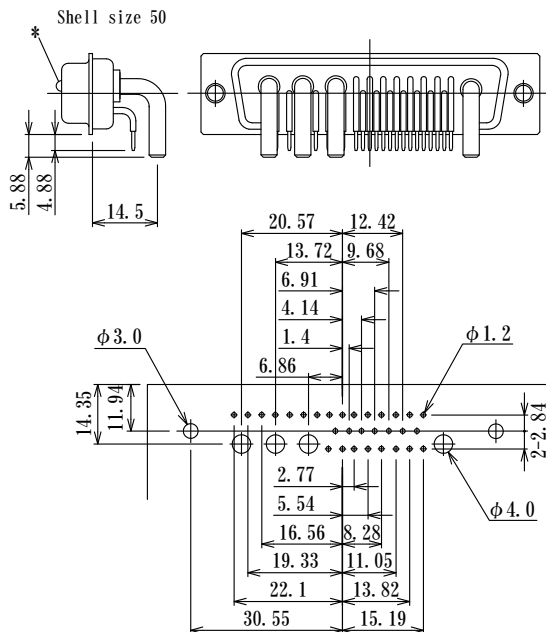

(注) Receptacle DDJ36W4の場合を示します。
(Plugの基板寸法は左右入替です。)

How to order (example)
DDJ36W4ES5 1pcs
DM537PH-PCE-L2 4pcs

Plug
DM537PH-PC-L2

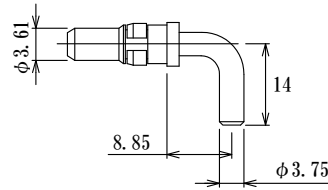

Receptacle
DM537RH-PC-L2

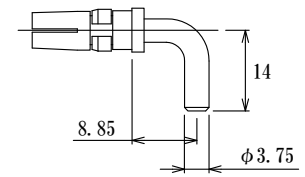

Current : 40A max

事前接地用コネクタ (Pre mating earth contact) *

Plug
DM537PH-PCE-L2

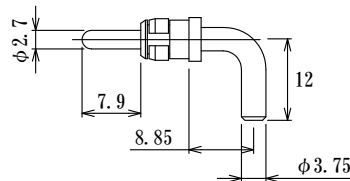

Receptacle
DM537RH-PCE-L2

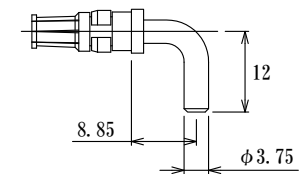

Current : 20A max

(注) *挿入時は他のピンより先に接触し、
抜去時は最後に非接触となります。

複合Dサブ、基板レイアウト Combination Dsub connectors, PC Board Layout

High Current Angle
Signal Pin Angle

高周波Dサブ 基板用ストレートタイプ のPlugを前から見たコンタクトレイアウトを示します。
Receptacleの場合は左右入替の基板寸法です。

<p style="text-align: center;">Shell Size 9</p> <div style="text-align: center;"> <p>5W1</p> </div>	<p style="text-align: center;">Shell Size 15</p> <div style="text-align: center;"> <p>3W3</p> </div>	<div style="text-align: center;"> <p>7W2</p> </div>
<p style="text-align: center;">Shell Size 15</p> <div style="text-align: center;"> <p>11W1</p> </div>	<p style="text-align: center;">Shell Size 25</p> <div style="text-align: center;"> <p>5W5</p> </div>	<div style="text-align: center;"> <p>9W4</p> </div>
<p style="text-align: center;">Shell Size 25</p> <div style="text-align: center;"> <p>13W3</p> </div>	<div style="text-align: center;"> <p>17W2</p> </div>	<div style="text-align: center;"> <p>21W1</p> </div>

複合Dサブ、基板レイアウト
Combination Dsub connectors, PC Board Layout

High Current Angle
Signal Pin Angle

Shell Size 37

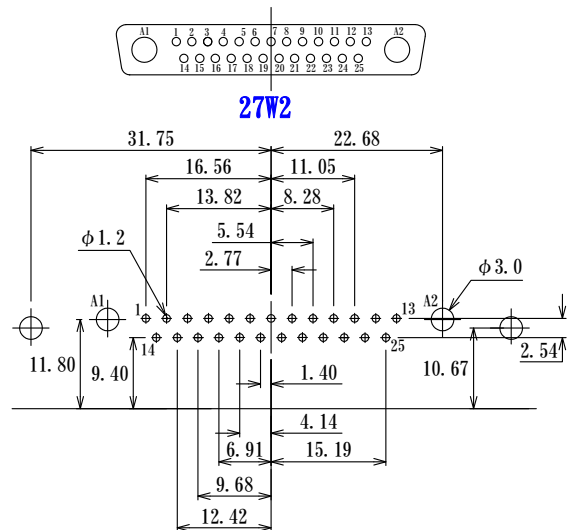
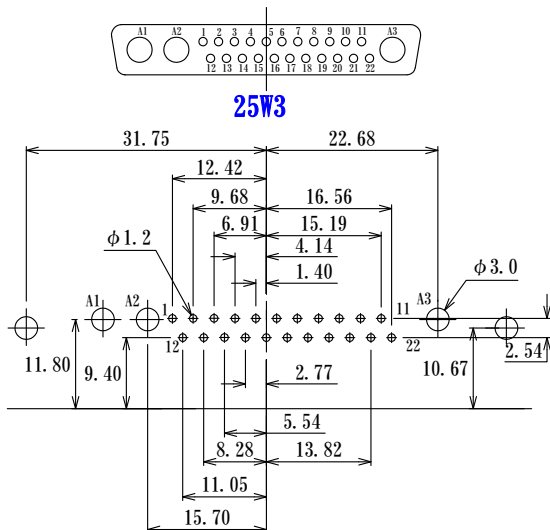
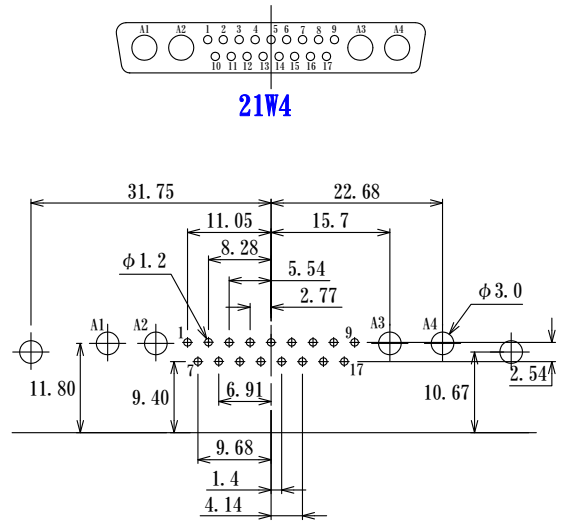
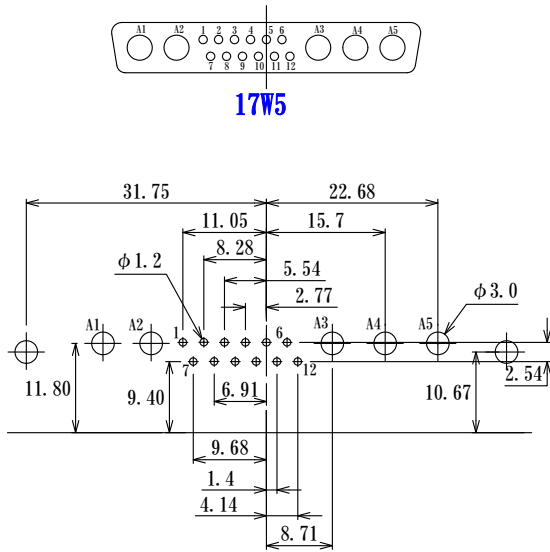
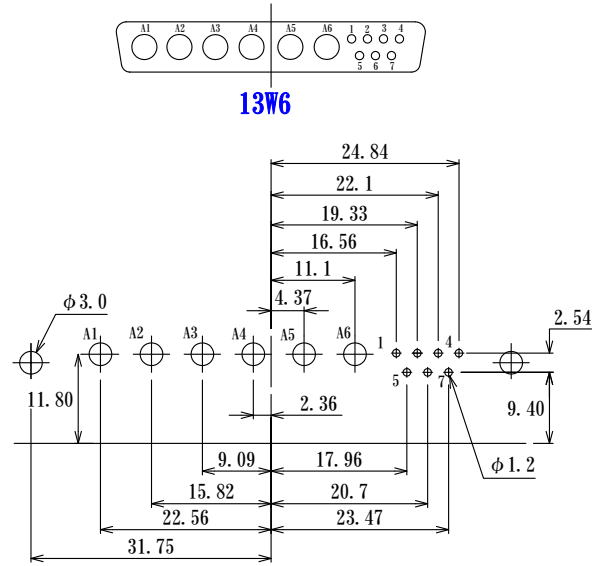
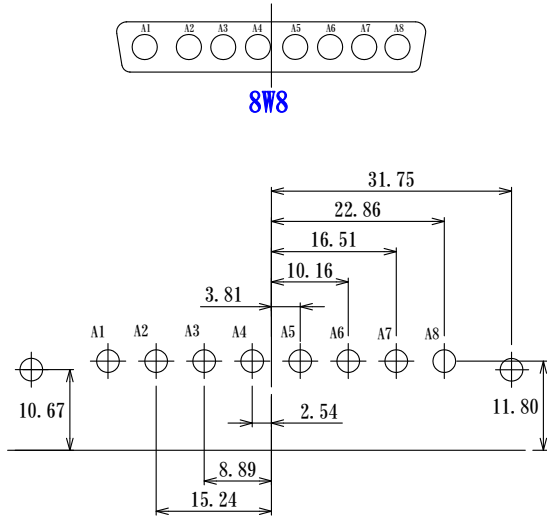

複合Dサブ、基板レイアウト
 Combination Dsub connectors, PC Board Layout

High Current Angle
 Signal Pin Angle

Shell Size 50

