

Acceptable Plug $\phi 0.60 \sim \phi 0.38\text{mm}$, Socket Pins

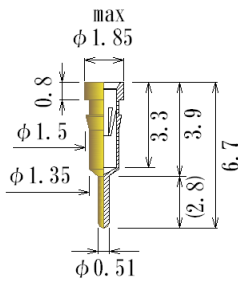

J0010-GG
(J-01contact)

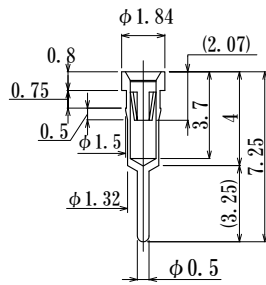

J0010-GG-JV11
(JV11contact, value type)

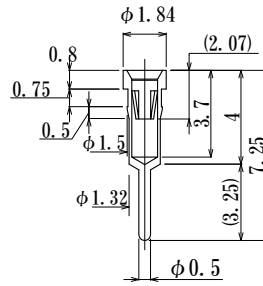

J0010-GG-634
(J-634contact, High force)

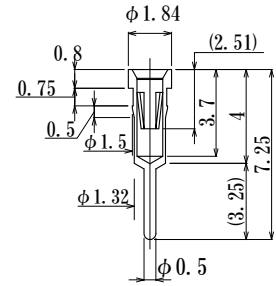

J0010-GG-856
(J-856contact, Low force, Six fingers)
受注生産品

受注生産品

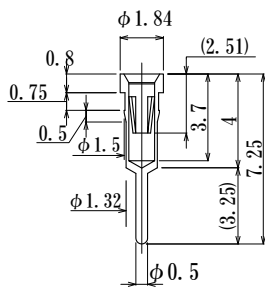

J0010-GG-ST
(Value type)

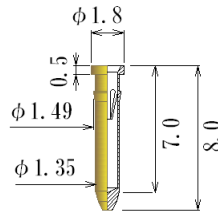

JSC0021-GG

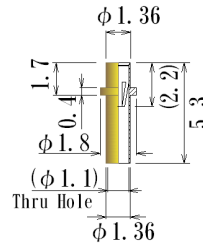

JOKP50-GG

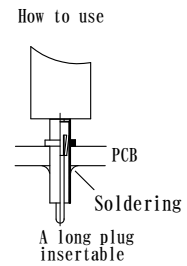

(J-01)

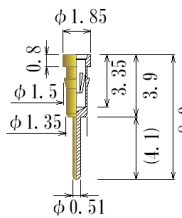

JL0020-GG

(J-01)

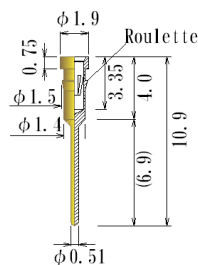

JLL0020-L-GG

Low Force

(J-03)

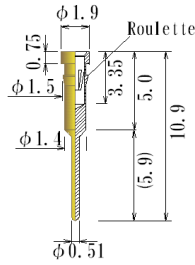

JLL0021-GG

(J-01)

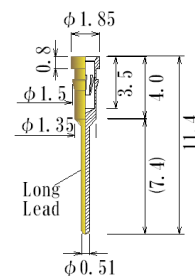

JL74X11.4-L-GG

Low Force

(J-03)

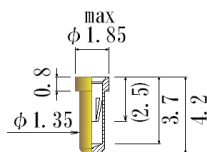
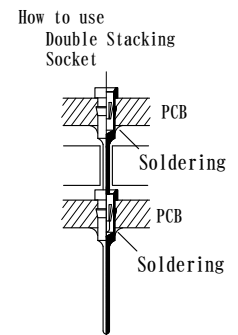

JS0020-GG

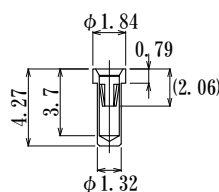

JS0020-GG-ST
(JV11contact, value type)

受注生産品

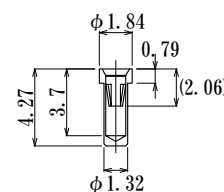

JS0020-GG-634
(J-634contact, High force)

受注生産品

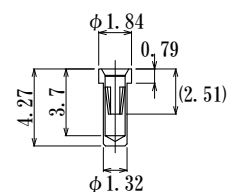

JS0020-GG-856
(J-856contact, Low force, Six fingers)
受注生産品

Acceptable Plug $\phi 0.60 \sim \phi 0.38\text{mm}$, Socket Pins

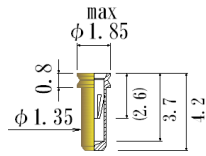

JSV0020-GG

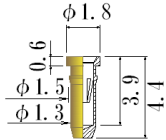

J021-GG

(J-01)

貫通ソケットピン
Thru Hole Socket Pin

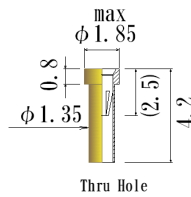

JSP0020-GG (スリーブ 金メッキ)
JSP0020-SN (スリーブ スズメッキ)

(J-01)

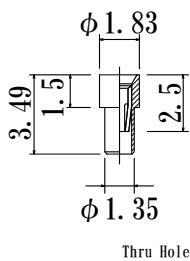
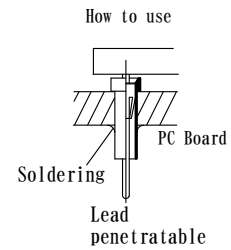

JSP0021-GG

(J-01)

底付き貫通ソケットピン
Thru Hole Socket Pin with
Silicone Seal

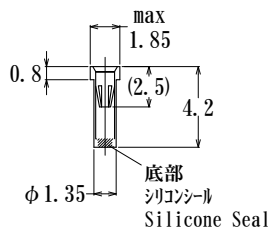

JSP0020-GG-TF

(J-01)

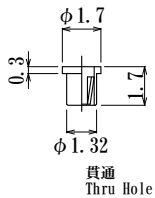
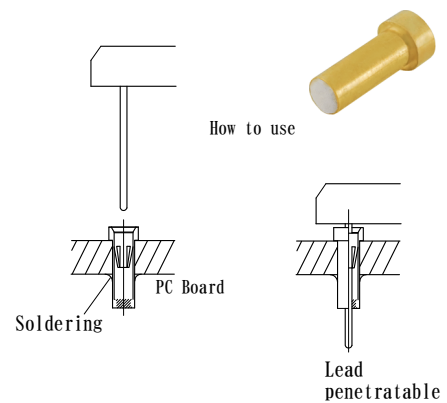

JSS17-GG

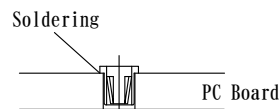

推奨クリーマント 塗布エリア
メタルマスク厚 Metal Mask thickness
100 μm ~ 150 μm

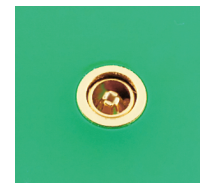

推奨メタルマスク寸法

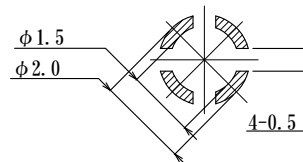
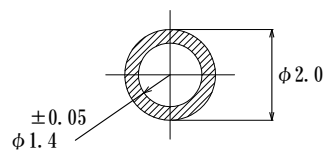

(JV11)

Acceptable Plug $\phi 0.60 \sim \phi 0.35\text{mm}$, Socket Pins

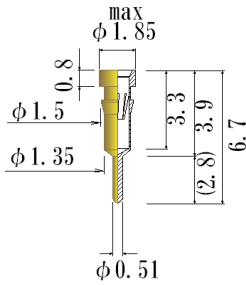

Acceptable plug:
 $\phi 0.60 \sim \phi 0.40$
J0010-L-GG

Low Force

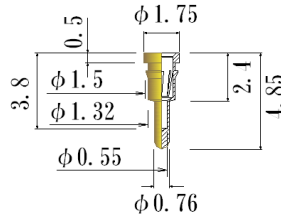

Acceptable plug:
 $\phi 0.60 \sim \phi 0.40$
JS0041-1L-GG

Low Force

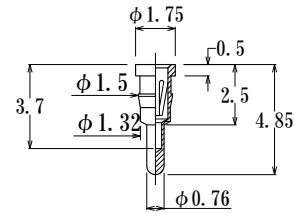

Acceptable plug:
 $\phi 0.60 \sim \phi 0.40$
JS0041B-GG

(J-03)

(J-01)

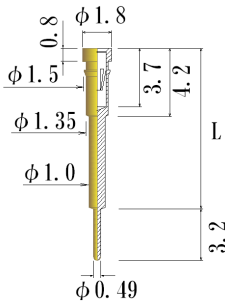

Parts Number	L Length
JH0060-GG	6.0
JH0080-GG	8.0
JH0102-GG	10.2
JH0120-GG	12.0
JH0150-GG	15.0

Acceptable Plug Range: $\phi 0.60 \sim \phi 0.35$

(J-01)

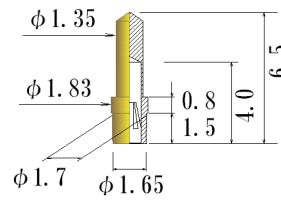

How to use

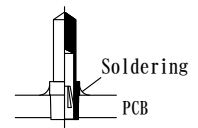

(J-01)

Acceptable Plug $\phi 0.60 \sim \phi 0.35\text{mm}$, Socket Pins

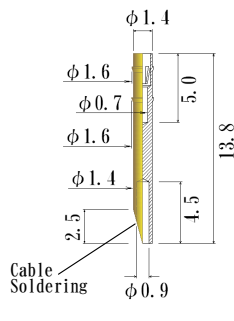

J1-0510TL-GG

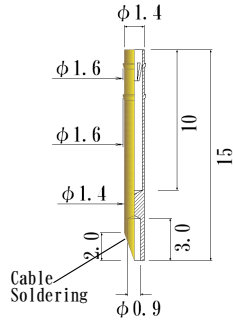

J1-0620CH-GG

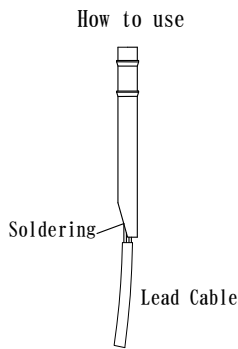

(J-01)

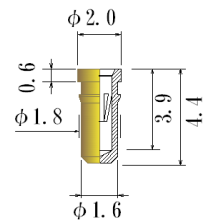

JN0020-GG

(J-01)

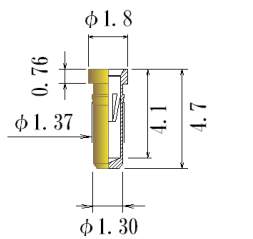

J0137-L-GG

Low Force
(J-03)

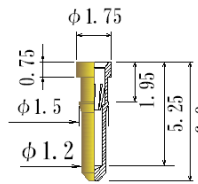

Acceptable plug:
 $\phi 0.60 \sim \phi 0.40$
JS0062-L-GG

Low Force
(J-03)

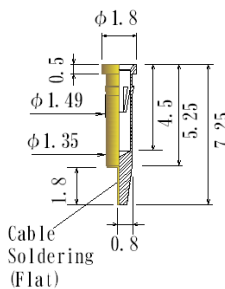

JSC0030-GG

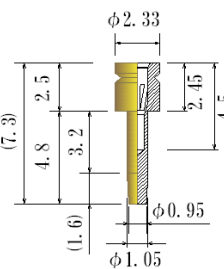

NSB11V-GG

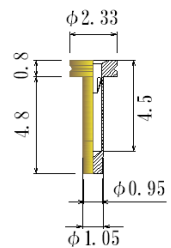

NSB10V-GG

(J-01)

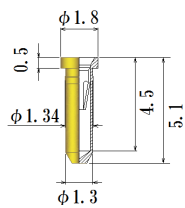

J051-GG

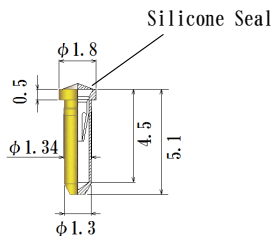

J051-SGG

Silicone Seal

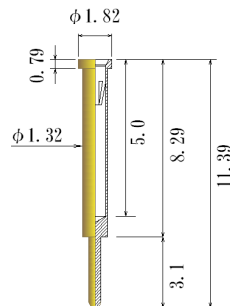

J1139LAN-GG

(J-01)

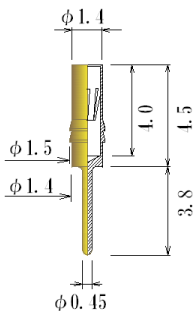

JZ0010-L-GG

Low Force

(J-03)

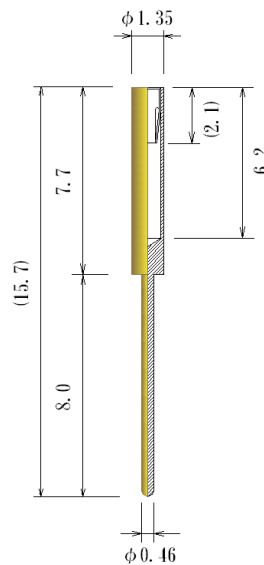
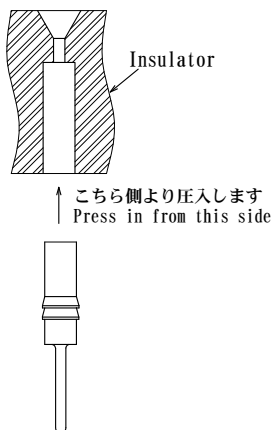

JS135KM-GG

(J-01)