

Test & Burn-In Socket, GQ29 molded frame series

Size 29x30.6mm / 1.14" x 1.20"

受注生産品
Make to order

Acceptable device size

Max □13mm/0.51"

In the case of larger size, consult factory.
Any device on 0.30mm pitch or larger

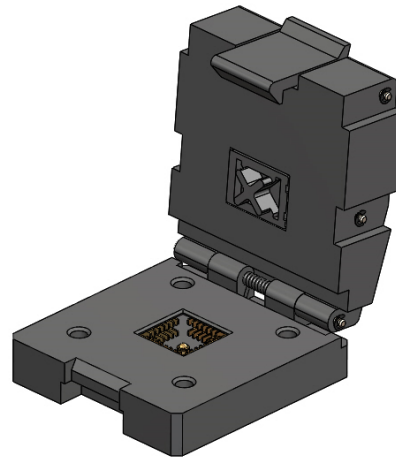

How to order
GQ29-QFN □□□□□□□□

P/N will be informed after fixing specifications.

example)
プレスソケット Stamping pin socket
actual size

In case QFN Device

Features:

- High reliability
- Cost competitive
- Short delivery time
- Temperature -40°C to +150°C (typical)

Dimensions and specifications:

- Top view: 30.6mm width, 29mm height, 14.75mm and 18mm internal widths, 7.1mm offset, 4-φ2.2 and 4-φ4.5 Depth 0.5 holes, φ1.53 (Ground Pin).
- Side view: 6.4mm total height, 2.4mm top section, 1.5mm bottom section, φ0.56 diameter, w0.25x0.2mm width.
- QFN Device view: 0.4mm height, 0.9mm width, 5.6mm length, 60pin.
- PCB Pattern (Top View): 30.6mm width, 23mm height, 14.75mm and 18mm internal widths, 15.6mm and 12.6mm offsets, 3-φ1.55±0.05mm holes, 60-φ0.4±0.1mm holes, 4-φ2.2mm holes (For M2 Screw), 0.4x14±5.6mm dimensions, 25.5mm total width, 14.2mm offset, 0.4mm gap, 0.4x14±5.6mm dimensions, 25.5mm total width.

Stand off Area
PCB Pattern (Top View)

mm

How to order

GQ29-BGA □□□□□□□□

P/N will be informed after fixing specifications.

In case BGA Device

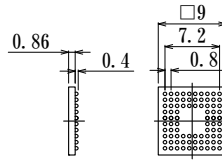

84pin

Features:

- High reliability
- Cost competitive
- Short delivery time
- Temperature -40°C to +150°C (typical)

example)

7° 0-7° ビンソケット Probe pin socket

actual size

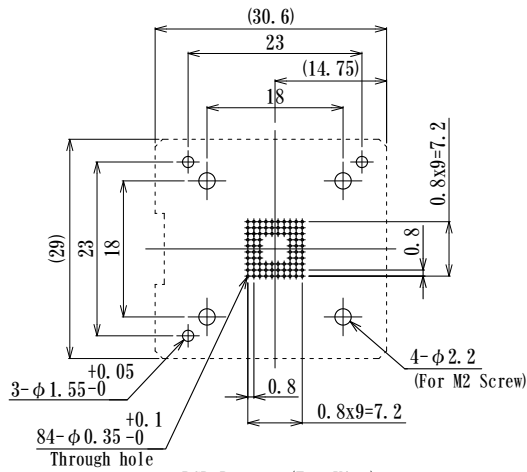
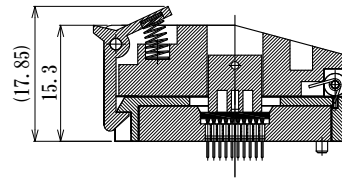
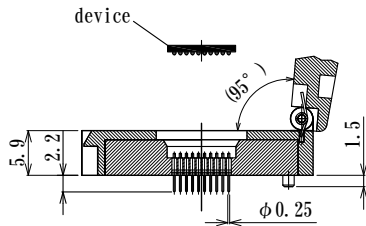
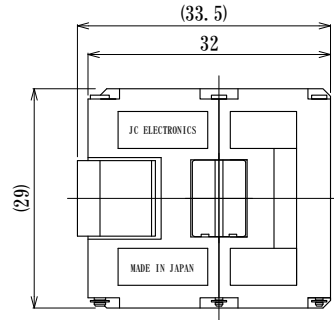
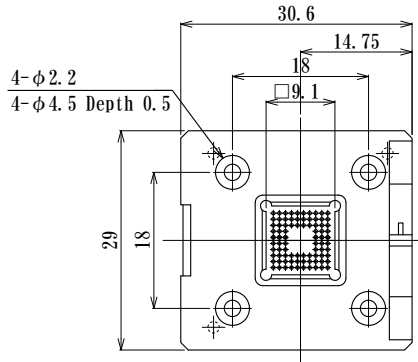

PCB Pattern (Top View)